



DiabeCHECK®

SAFETY BLOOD LANCETS

DC-305SL

Safe

- Needle fully shielded before and after use
- Sterilised by gamma irradiation

Comfortable

- High quality tri-bevel needle
- High speed penetration
- Tri-level ground tip keeps good blood flow

Easy to use

- Preloaded and pressure activated
- No lancing device required
- Simple activation by single push



INSTRUCTIONS FOR USE

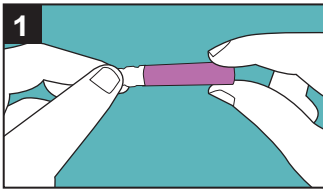

1 Rotate the twisting cap less than half a round

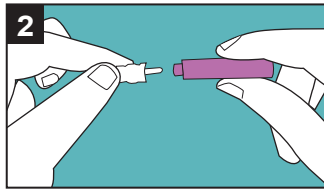

2 Pull out the twisting cap

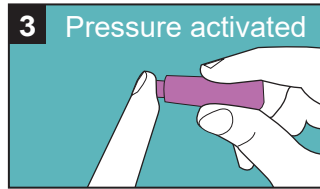

3 Pressure activated
Place the device on the puncture site and push to start

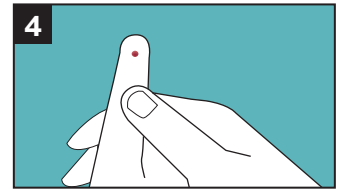







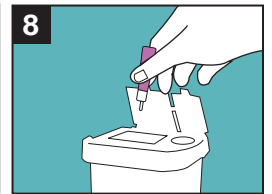
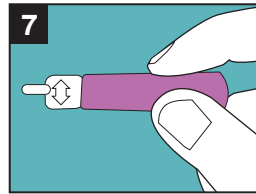
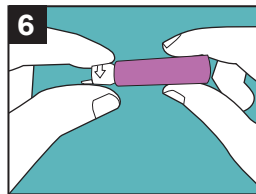
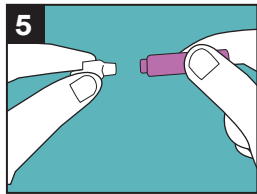





4 Press lightly on the finger towards the puncture site to obtain an adequate blood sample

DISPOSAL

Push the cap into the used safety lancet reversely until the cap is fully secured. Then discard lancet into a sharps container



PRODUCT FAMILY

SAFETY LANCET	PART NUMBER	BLOOD FLOW
	DC-305SL (30G/1.5mm)	
	DC-305SL (28G/1.8mm)	
	DC-305SL (26G/1.8mm)	
	DC-305SL (23G/2.2mm)	
	DC-305SL (21G/2.2mm)	
	DC-305SL (Blade/2.2mm)	

Authorised Distributor: